

**Thank you for choosing a NIVELCO instrument.
We are sure that you will be satisfied throughout its use!**

1. APPLICATION

Resistance thermometers are the fundamental elements of the industrial process control. The design of the TGP-□□□□ resistance thermometer-family enables temperature metering in industrial applications. Primarily they can be used for fast bearing temperature measurement of high-performance machines.

2. TECHNICAL DATA

Process temperature	-50 °C ... +180 °C
Sensor	Pt 100
Accuracy class	A, B (as per EN 60751)
Measuring current	1 mA
Housing material	1.4571 stainless steel
Electrical connection	silicone rubber and shield, 3 x 0.75mm ²
Mechanical connection	As order code
Cable protection	tinned protective jacket
Cable length	6 m
Cable diameter	7 mm
Insertion length	30, 50, 100, 160, 380 mm
Mechanical protection	IP 65
Electrical protection	Class III.
Insulation resistance	min. 10 MΩ at 20 °C ± 5 °C
	min. 1 MΩ at the highest operating temperature
Voltage test	500 V, 50 Hz AC for 1 min., at 20 °C ± 5 °C
Mass	0.55 kg
Time constant (9 / 10)	< 20 sec.
Pressure	max. 6 MPa

2.1. ACCESSORIES

- User's manual
- Warranty Card
- Declaration of Conformity

tgp1120a0600h_03 • 1/2

THERMOCONT TGP

BEARING TEMPERATURE SENSORS

USER'S MANUAL



NIVELCO



ООО "РусАвтоматизация"

454010 г. Челябинск, ул. Гагарина 5, оф. 507
 тел. 8-800-775-09-57 (звонок бесплатный),
 тел.: (351)799-54-26, тел./факс (351)211-64-57
info@rusautomation.ru; www.rusautomation.ru
[русавтоматизация.pdf](#)

2.2. ORDER CODE

T G P -

Process connection	Code	Sensor	Code	Probe (L)	Code
Rimmed	1	Class A Pt 100	1	30 mm	1
M20 x 1.5	2	Class B Pt 100	2	50 mm	2
				100 mm	3
				160 mm	4
				380 mm	5

2.3. DIMENSIONS

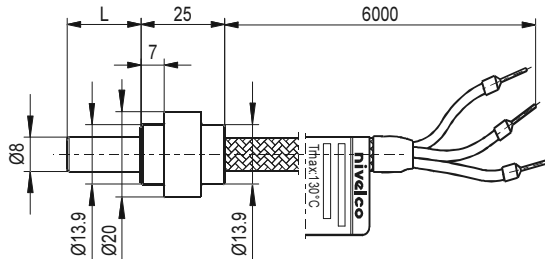

Rimmed connection

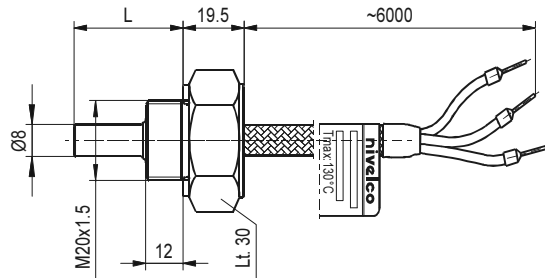

M20 x 1.5 threaded connection

3. MOUNTING

The thermal sensor can be mounted into the $\varnothing 8$ mm hole which is suitable for the insertion length.

4. WIRING

One terminal of the Pt100 temperature sensor is the two wires marked with the same colour and the third unmarked wire is the other terminal of the Pt100.

Therefore 2- or 3-wire sensor wiring is also possible.

5. MAINTENANCE, REPAIR

The unit does not require regular maintenance. All repairs will be carried out at the manufacturer's premises.

6. STORAGE CONDITIONS

Ambient temperature: $-25^{\circ}\text{C} \dots +55^{\circ}\text{C}$

Relative humidity: max. 98 %

7. WARRANTY

NIVELCO provides warranty of 3 (three) years in compliance with details described in the Warranty Card.

tgp1120a0600h_03

March 2015

NIVELCO reserves the right to change technical specifications without notice.