

## Magnetostrictive Position Sensor

- Measuring range 100 - 5000 mm
- 16 bit resolution
- Output 0...10V, 0...20mA, 4...20mA  
10...0V, 20...0mA, 20-4mA  
0...10V - 10...0V, 4...20mA - 20...4mA  
0...20mA - 20...0mA
- 24 VDC power supply



### Technical specifications

Measurement stroke	100 to 5000 mm
Resolution	16 bit DAC output
Repeatability	±0,005% (full scale)
Output	0-10 V, 4-20 mA, 0-20 mA / 10-0 V, 20-4 mA, 20-0 mA 0-10V - 10-0V / 4-20mA - 20-4mA / 0-20mA - 20-0mA
Power supply	24 VDC ±10%
Displacement speed	< 10 m/s
Sampling rate	up to 2 kHz (depending on stroke length)
Max. consumption	50 mA - 90 mA (depending on stroke length)
Max. output noise	< 5 mVpp
Max. output value	10.5 V
Linearity	±0,02% full scale (min. 100 µm)
Update time	0,5 ms up to 1000 mm / 0,8 ms up to 4000 mm
Reverse polarity protection	Up to -30 VDC
Overtoltage protection	Up to 28 VDC
IP protection	IP 65

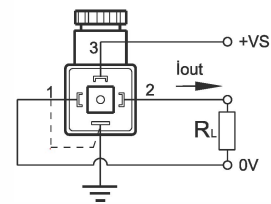

0-20mA, 4-20mA Output  
Hydraulic type connector

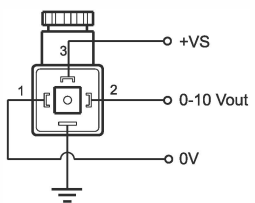

0-10V Output (single)  
Hydraulic type connector

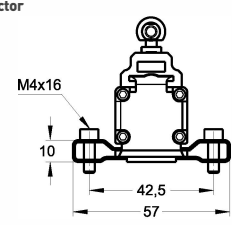
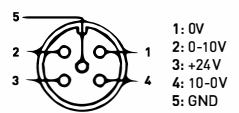

Optional bracket (BR01)

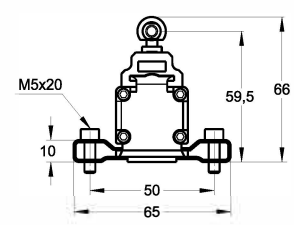

Standard bracket (BR02)

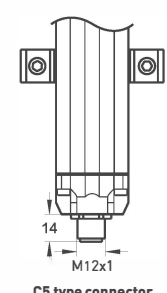

C5 type connector

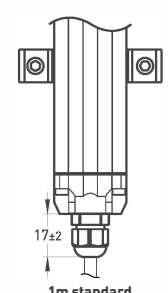

1m standard cable type

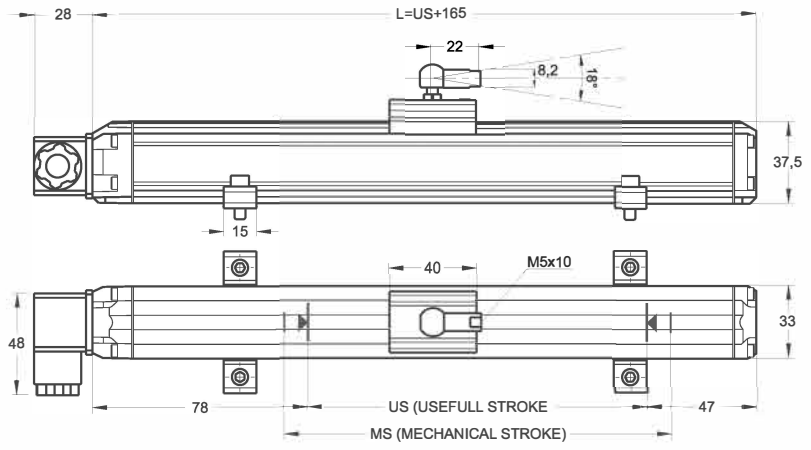

MSW (mm)	100	150	200	250	300	350	400	450	500	550	600	650	700	750	800	850	900	1000	1100	1200	1300	1400	1500	1750	2000	2250	2500	3000	4000	5000
US (Usefull Stroke)	140	190	240	290	340	390	440	490	540	590	640	690	740	790	840	890	940	1040	1140	1240	1340	1440	1540	1790	2040	2290	2540	3040	4040	5040
MS (Mechanical Stroke)	160	210	280	310	360	410	460	510	560	610	660	710	760	810	860	910	960	1060	1160	1260	1360	1460	1560	1810	2060	2310	2560	3060	4060	5060
L (Total Length)	265	315	365	415	465	515	565	615	665	715	765	815	865	915	965	1055	1015	1165	1265	1365	1465	1565	1665	1915	2165	2415	2665	3165	4165	5165

Model	Measurement stroke	Resolution	Cursor	Output	Connector / Cable	Bracket	Dead zone
MSW	300	A	1C	V10	C1	BR02	78/47
MSW	100 ... 5000 mm	A: 16 bit	1C: 1 cursor 2C: 2 cursor	V10: 0 - 10 V V01: 10 - 0 V I40 : 4 - 20 mA I20 : 0 - 20 mA I04 : 20 - 4 mA V11: 0 - 10 V / 10 - 0 V I41 : 4 - 20 mA / 20 - 4 mA I21 : 0 - 20 mA / 20 - 0 mA	C1 : 4 pin connector C5 : 5 pin connector (M12x1) C8 : 8 pin connector 1M: 1 meter cable	BR01: Optional bracket BR02: Standard bracket	78/47