

Optic Rotary Incremental Encoder

- 58 mm case diameter
- 100 - 200 - 360 - 400 - 500 - 600 - 720 - 1000 - 1024
1800 - 2000 - 2048 - 2500 ppr.
- Push-Pull, TTL Linedriver and HTL Linedriver outputs
- Shaft diameter 11 mm
- 3500 rpm max.



Technical Specifications

| | |
|---------------------------------------|---|
| Resolution | 100 to 2500 ppr. |
| Output Channels | A,B,Z or A,Ā, B,Ā, Z,Z̄ |
| Output Type | Push-Pull, TTL Linedriver, HTL Linedriver |
| Supply Voltage | 5 VDC or 8 - 24 VDC or 5 - 24 VDC |
| Power Consumption (without load) | < 40 mA (24 VDC) |
| Cable | 2.5m (standard) 5 wire + Shield (Push-Pull) 2.5m (standard) 8 wire + Shield (Linedriver) |
| Max. Permissible Shaft Loading Radial | 60 N |
| Axial | 40 N |
| Max. Speed | 3500 rpm |
| Shaft Diameter | Ø11 mm |
| Shaft Material | Stainless steel |
| Case Diameter | Ø58 mm |
| Case Material | Aluminium and painted steel |
| IP Degree | IP 54 |
| Operating Temperature | -20°C ... +80°C |
| Storage Temperature | -30°C ... +90°C |

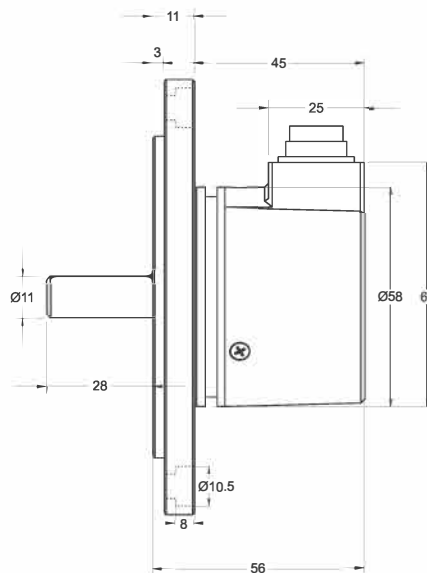
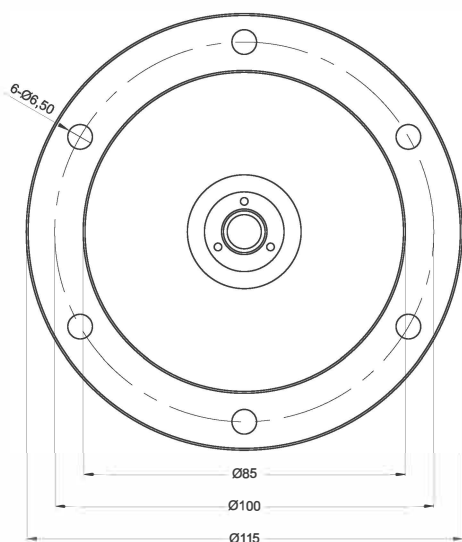

| Model | Case Diameter | Case Type | Shaft Diameter | Output Type | Resolution | Output Channels | Supply Voltage | Connector / Cable | Cable Output |
|---------------|---------------|------------------|----------------|---|-------------------|--------------------|---|--|--------------|
| (example) PRI | 58 | RK | R11 | HLD | 1024 | Z | V2 | 2M5 | R |
| PRI | 58mm | RK: Tacho flange | R11: 11mm | LTP : Push-Pull LD : TTL Linedriver HLD: HTL Linedriver | 100 ... 2500 ppr. | Z: A,B,Z B: A,B | V1: 5 VDC V2: 8-24 VDC V3: 5-24 VDC | 2M5: 2,5 meter cable 5M : 5 meter cable 8M : 8 meter cable 10M: 10 meter cable C12: 12 pin connector | R: Radial |